

SAVE UP TO 35%

# Spring Sale

PLAYGROUNDS | SITE AMENITIES | SHELTER | SHADE





SAVE  
BIG

## What's Inside?

- 01 Sale Inspirations
- 05 Play Structures
- 18 Shade & Shelter
- 20 Amenities & Bleachers

---

### What are sale inspirations?

Check out our sale inspirations — full environments created from only products that are on sale!



SAVE  
\$3,900+



## Keep Students Active

This active outdoor play area targets specific muscle groups while keeping your students moving! Featuring all sale items, this small space packs punch without the price.

A. 6' Plasti-Plank Bench • \$349 • Page 23

B. 5-12 Age Active Structure • \$6,106 • Page 12

C. Two-Bay Arch Swings • \$1,713 • Page 15

+ Bundle one of our sale structures with qualifying Superior shades for an additional 5% off. (Pictured: SD202010IG for \$3,492)





SAVE  
\$1,000+

## Keep Fans Comfortable

Every tennis court or sports field needs bleachers and shade to keep fans comfortable. Featuring all sale items, this space will have your fans cheering from the shaded stands.

A. 15' Length 5 Row Bleacher • \$3,657.50 • Page 23

+ Bundle one of our sale bleachers with its accompanying Superior shade and receive 5% off the shade. Flip to page 23 for more details.



SAVE  
\$3,000+

A

B

C

## Keep Your Cool

This shaded outdoor area provides all the amenities to keep your guests comfortable. Featuring all items that are on sale, this shaded space will be the perfect summer picnic spot.

A. 16' x 24' Shelter • \$9,492 • Page 19

B. 32 Gallon Horizontal Strap Trash Receptacle • \$363 • Page 21

C. 6' Plasti-Plank Table • \$783 • Page 23



SAVE  
\$7,000+

## Keep Children Developing

This physical and dramatic play area will have great developmental benefits for children aged 2-5! Featuring sale items, this space is perfect for a child care or church environment.

- A. PS3-32555 • \$11,311 • Page 7
- B. Arch Bridge • \$2,673 • Page 16
- C. Trike Track • \$2,928 • Page 16





06 **6-23 Months**  
06 **Ages 2-5**  
09 **Ages 2-12**  
12 **Ages 5-12**  
15 **Independent  
Play**

# **PLAY** **STRUCTURES**

Ages 6-23  
Months

**SAVE  
\$3,375**



**R3-20189** \$6,268 REG. PRICE: \$9,643 900 lbs. of recycled material

| Capacity | Structure Size | Use Zone  | Fall Height | Timber Count | ADA |
|----------|----------------|-----------|-------------|--------------|-----|
| 9        | 12' x 6'       | 24' x 18' | 2'          | N/A          | ✓   |



**SAVE  
\$4,361**



**Ages 2-5**

**PS3-32646** \$8,099 REG. PRICE: \$12,461

| Capacity | Structure Size | Use Zone  | Fall Height | Timber Count | ADA |
|----------|----------------|-----------|-------------|--------------|-----|
| 12       | 15' x 4'       | 27' x 16' | 3'          | 18           | ✓   |

Features our  
Din-O-Find  
Activity Panel Set





SAVE  
\$6,031



**R3-20207** \$11,200 REG. PRICE: \$17,231 1,370 lbs. of recycled material

| Capacity | Structure Size | Use Zone  | Fall Height | Timber Count | ADA |
|----------|----------------|-----------|-------------|--------------|-----|
| 9        | 17' x 20'      | 29' x 32' | 4'          | 25           | ✓   |



SAVE  
\$6,091



**PS3-32555** \$11,311 REG. PRICE: \$17,402

| Capacity | Structure Size | Use Zone  | Fall Height | Timber Count | ADA |
|----------|----------------|-----------|-------------|--------------|-----|
| 20       | 16' x 13'      | 28' x 25' | 3'          | 22           | ✓   |



Ages 2-5



 SAVE  
\$6,495

**PS3-32511** \$12,062 REG. PRICE: \$18,556

| Capacity | Structure Size | Use Zone  | Fall Height | Timber Count | ADA |
|----------|----------------|-----------|-------------|--------------|-----|
| 28       | 22' x 15'      | 34' x 27' | 3'          | 26           | ✓   |



 SAVE  
\$7,599

**PS3-32647** \$14,112 REG. PRICE: \$21,711

| Capacity | Structure Size | Use Zone  | Fall Height | Timber Count | ADA |
|----------|----------------|-----------|-------------|--------------|-----|
| 32       | 23' x 19'      | 35' x 31' | 4'          | 28           | ✓   |

 Features our  
Transportation  
Activity Panel Set



**SAVE  
\$8,081**



**R3-20209 \$15,007** REG. PRICE: \$23,088 🏋️ 1,700 lbs. of recycled material

| Capacity | Structure Size | Use Zone  | Fall Height | Timber Count | ADA |
|----------|----------------|-----------|-------------|--------------|-----|
| 28       | 27' x 19'      | 39' x 31' | 4'          | 31           | ✓   |



**SAVE  
\$6,089**



**R3-20198 \$11,309** REG. PRICE: \$17,398 🏋️ 1,935 lbs. of recycled material

| Capacity | Structure Size | Use Zone  | Fall Height | Timber Count | ADA |
|----------|----------------|-----------|-------------|--------------|-----|
| 23       | 31' x 13'      | 43' x 25' | 7'          | 23           | N/A |



**Ages 2-12**

**Ages 2-12**



**SAVE  
\$6,135**

**PS3-32634** \$11,393 REG. PRICE: \$17,528

| Capacity | Structure Size | Use Zone  | Fall Height | Timber Count | ADA |   |
|----------|----------------|-----------|-------------|--------------|-----|---|
| 28       | 22' x 14'      | 34' x 26' | 5'          | 24           | ✓   |  |

**SAVE  
\$6,372**

**PS3-32645** \$11,833 REG. PRICE: \$18,204

| Capacity | Structure Size | Use Zone  | Fall Height | Timber Count | ADA |   |
|----------|----------------|-----------|-------------|--------------|-----|---|
| 24       | 22' x 19'      | 34' x 31' | 4'          | 26           | ✓   |  |

 Features our  
Pirate Find  
Activity Panel Set

**SAVE  
\$7,660**



**PS3-32556** \$14,226 REG. PRICE: \$21,886

| Capacity | Structure Size | Use Zone  | Fall Height | Timber Count | ADA |
|----------|----------------|-----------|-------------|--------------|-----|
| 28       | 21' x 18'      | 33' x 30' | 6'          | 26           | ✓   |



**SAVE  
\$8,212**



**PS3-32549** \$15,251 REG. PRICE: \$23,464

| Capacity | Structure Size | Use Zone  | Fall Height | Timber Count | ADA |
|----------|----------------|-----------|-------------|--------------|-----|
| 30       | 23' x 21'      | 35' x 33' | 4'          | 28           | ✓   |



Agas 2-12



**SAVE  
\$3,288**

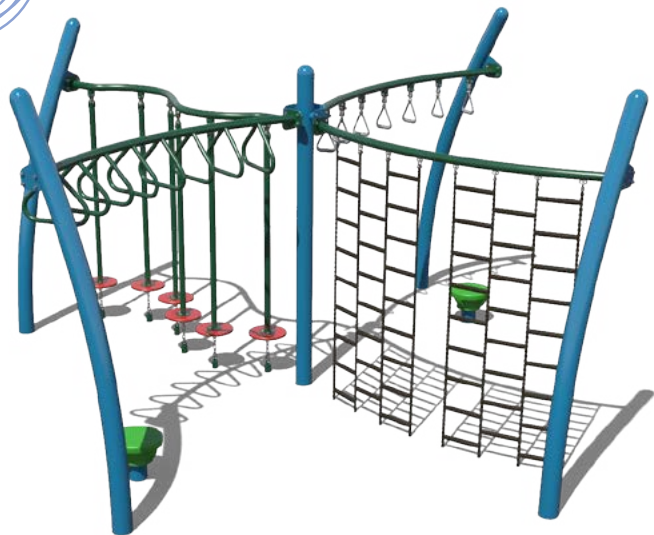

**PA5-32616** \$6,106 REG. PRICE: \$9,394

| Capacity | Structure Size | Use Zone  | Fall Height | Timber Count | ADA |
|----------|----------------|-----------|-------------|--------------|-----|
| 12       | 18' x 18'      | 30' x 30' | 7'          | 26           | ✓   |



**SAVE  
\$5,591**



**PS3-32643** \$10,384 REG. PRICE: \$15,975

| Capacity | Structure Size | Use Zone  | Fall Height | Timber Count | ADA |
|----------|----------------|-----------|-------------|--------------|-----|
| 26       | 24' x 18'      | 36' x 30' | 5'          | 28           | ✓   |

Features our Transportation Activity Panel Set



**SAVE  
\$7,964**



Features our  
Monster Seek  
Activity Panel Set



**SAVE  
\$10,720**



Agas 5-12

**PS-32642 \$14,791** REG. PRICE: \$22,755

| Capacity | Structure Size | Use Zone  | Fall Height | Timber Count | ADA |   |
|----------|----------------|-----------|-------------|--------------|-----|---|
| 26       | 22' x 12'      | 34' x 24' | 7'          | 24           | ✓   | + |

**PS-32539 \$19,909** REG. PRICE: \$30,630

| Capacity | Structure Size | Use Zone  | Fall Height | Timber Count | ADA |   |
|----------|----------------|-----------|-------------|--------------|-----|---|
| 36       | 26' x 23'      | 38' x 35' | 7'          | 34           | ✓   | + |





 SAVE  
\$11,521

**R3-20208** \$21,396 REG. PRICE: \$32,916  3,170 lbs. of recycled material

| Capacity | Structure Size | Use Zone  | Fall Height | Timber Count | ADA |
|----------|----------------|-----------|-------------|--------------|-----|
| 32       | 34' x 28'      | 46' x 40' | 7'          | 36           | ✓   |



 SAVE  
\$12,609



**R3-20195** \$23,417 REG. PRICE: \$36,027  3,900 lbs. of recycled material

| Capacity | Structure Size | Use Zone  | Fall Height | Timber Count | ADA |
|----------|----------------|-----------|-------------|--------------|-----|
| 47       | 35' x 22'      | 47' x 34' | 7'          | 37           | ✓   |



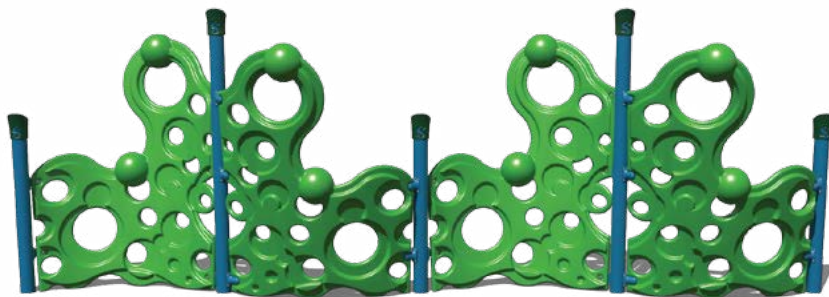

A



B

## Independent Events

### SAVE UP TO \$1,196!

#### A. Mole Hill Matrix Climber \$4,794

Use Zone: 26' x 26'

Item #: 87000010XX

REGULAR PRICE: \$5,993

#### B. Half Bubble Wall Climber \$2,174

Use Zone: 14' x 30'

Item #: AFR0090XX

REGULAR PRICE: \$2,717

#### C. 3.5" Arch Swing Frame \$1,109

Item #: 90015201XX

REGULAR PRICE: \$1,386

**Add-A-Bay** \$604

Item #: 90915200XX

#### D. Baseball Spin About \$902

Use Zone: 15' x 15'

Item #: TFR16588XX

REGULAR PRICE: \$1,128

#### Also On Sale

Our Football, Soccer Ball, Volleyball, and Original designs are also on sale.

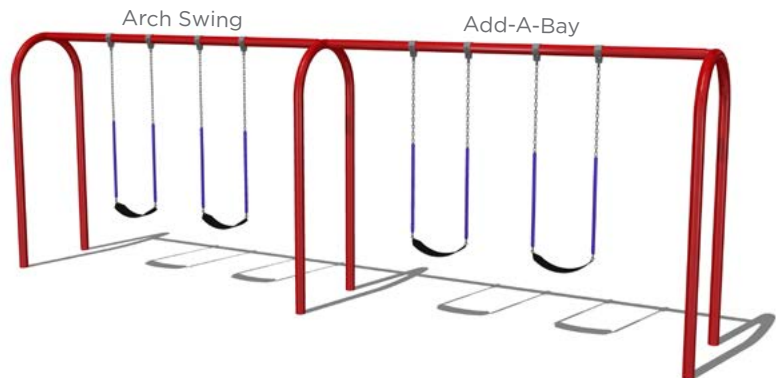

C



D

ALL  
DESIGNS  
ON SALE!





**SAVE UP TO \$732!**

**A. Trike Track \$2,928**

Item #: PS3-28227

**REGULAR PRICE: \$3,660**

*Includes Freestanding Gas Station, Freestanding Store Front, 2 Talk Tubes, and your choice of 3 Traffic Signs.*

*Rubber track not included, Arch Bridge sold separately (see below).*

**B. Arch Bridge \$2,673**

Item #: TFR13389XX

**REGULAR PRICE: \$3,341**

**Need surfacing for your Trike Track?**

Superior offers Poured-In-Place (PIP) surfacing, a great option that creates a smooth surface and allows for custom designs such as a road.



**SAVE UP TO \$2,610!**

**A. 8' Tri-Chute Slide \$7,373**

Use Zone: 20' x 37' 9"

Item #: AFR0187XX

REGULAR PRICE: \$9,983

**B. Zig-Zag Balance Beam \$286**

Use Zone: 15' x 19'

Item #: 90021016XX

REGULAR PRICE: \$358

**C. Cottage \$3,779**

Dimensions: Approx. 3¼' x 6¼' x 4¾'

Item #: TFR0560XX

REGULAR PRICE: \$4,724

Colors are as shown.





**SHADE &  
SHELTER**



A



B



C



D



E



F

## Shade & Shelter

**SAVE UP TO \$2,373!**

### A. Hexagon Umbrella Shade

**16' Foot** \$1,925  
Item #: HU161608IG  
REGULAR PRICE: \$2,406.60

**18' Foot** \$2,366  
Item #: HU181808IG  
REGULAR PRICE: \$2,957.85

### B. 20' Square Shade \$2,386

Item #: SD202008IG  
REGULAR PRICE: \$2,982

### C. 13' Skyspan Cabana \$3,543

Item #: C40S  
REGULAR PRICE: \$4,428.90  
*Curtains and drapery sold separately.*

### D. 16' Hypar Umbrella \$4,200

Item #: HYP50S  
REGULAR PRICE: \$5,250

### E. 16' x 24' Shelter \$9,492

Item #: HE1624-AS  
REGULAR PRICE: \$11,865

### F. Message Board \$2,704

Item #: THREE-SIDEDMESSAGE  
REGULAR PRICE: \$3,380



21 **Site Amenities**  
23 **Bleachers**



# AMENITIES & BLEACHERS

# Save BIG on Site Amenities with 3 deals!

1

Save 15% on select amenities, including our **NEW** Horizontal Strap design!

2

Buy one, get one 50% off our Villa Classic, Standard Classic, and Metro benches.

3

Save 5% on our **NEW**, non-elevated 5 row bleachers!

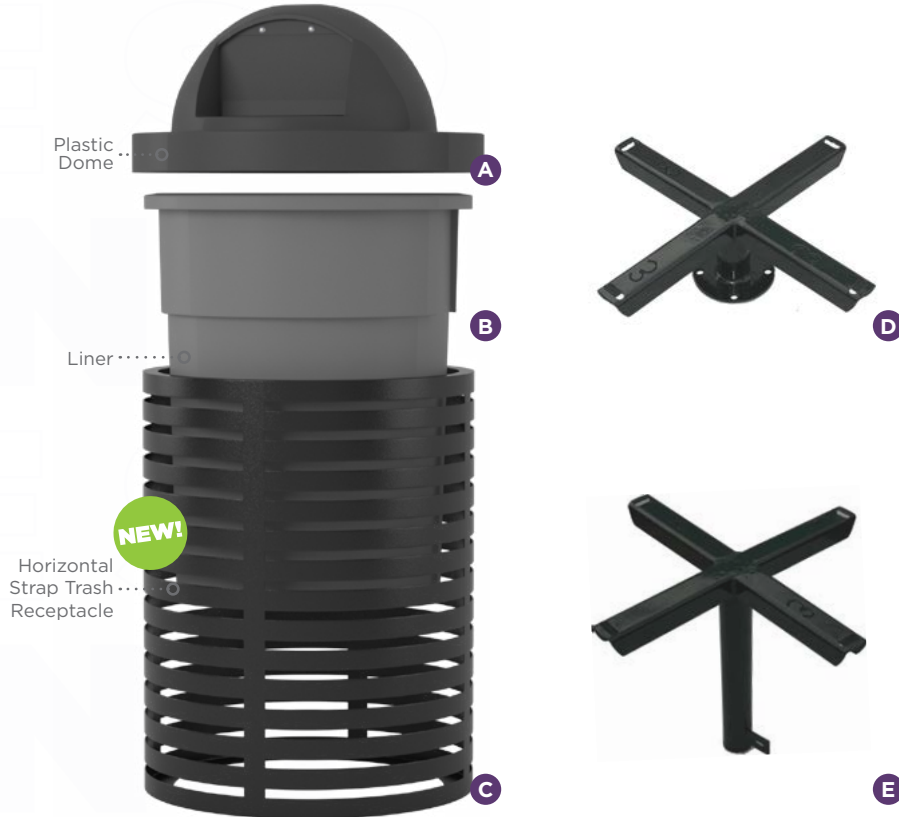

## Site Amenities SAVE UP TO \$85!

### A. Trash Receptacle Tops

**32 Gallon Flat Top** \$78.54  
Item #: FLATTOP  
REGULAR PRICE: \$92.40

**Plastic or Steel Dome Top** \$83.90  
Plastic: DOME32 Steel: DOME32S  
REGULAR PRICE: \$98.70

### B. 32 Gallon Liner

|                      |                     |
|----------------------|---------------------|
| <b>Black</b> \$26.78 | <b>Gray</b> \$26.78 |
| LINER32-BLACK        | LINER32-GRAY        |
| PRICE: \$31.50       | PRICE: \$31.50      |

### C. Horizontal Strap Trash Receptacle

|                           |                           |
|---------------------------|---------------------------|
| <b>22 Gallon</b> \$316.84 | <b>32 Gallon</b> \$363.25 |
| TR22HORZ                  | TR32HORZ                  |
| PRICE: \$372.75           | PRICE: \$427.35           |

### D. Surface Mounting

**Surface Mount** \$40.16  
Plastic: TR-SM  
REGULAR PRICE: \$47.25

### E. In-ground Mounting

**In-ground Mount** \$40.16  
Item #: TR-ING  
REGULAR PRICE: \$47.25





### SAVE UP TO \$230!

#### A. Horizontal Strap Bench

**6' Foot** \$843.41  
Item #: B6WBHORZCASINO  
REGULAR PRICE: \$992.25

#### B. BOGO! Villa Classic Bench

**4' Foot** \$732.90    **6' Foot** \$925.08  
B4WBVILLAEXP    B6WBVILLAEXP

#### C. BOGO! Metro Bench

**4' Foot** \$1,022.70    **6' Foot** \$1,533  
B4WBMETRO    B6WBMETRO

#### D. BOGO! Standard Classic Bench

**4' Foot** \$886.20    **6' Foot** \$1,031.10  
B4WBCLASSIC    B6WBCLASSIC

**5' Foot** \$931.35  
B5WBCLASSIC

*\*Discount is applied to lesser item.  
Only available in our textured polyethylene.*



NEW!



NEW!



**SAVE UP TO \$309!**

**A. Plasti-Plank Portable Table**

|  |  |
|--|--|
| <b>6' Foot</b> \$782.72<br>T6PP<br>PRICE: \$920.85 | <b>8' Foot</b> \$955.87<br>T8PP<br>PRICE: \$1,124.55 |
|--|--|

**B. Plasti-Plank Bench**

|   |   |
|---|---|
| <b>6' Foot</b> \$348.97<br>B6WBPPXX*<br>PRICE: \$410.55 | <b>8' Foot</b> \$427.51<br>B8WBPPXX*<br>PRICE: \$502.95 |
|---|---|

\*Replace "XX" with mounting option.

**C. 5 Row Bleachers**

**15' Length** \$3,657.50  
Item #: BL515NE  
**REGULAR PRICE: \$3,850**  
*Receive 5% off TC201411IG shade*

**21' Length** \$4,156.25  
Item #: BL521NE  
**REGULAR PRICE: \$4,375**  
*Receive 5% off TC261411IG shade*

**27' Length** \$4,987.50  
Item #: BL527NE  
**REGULAR PRICE: \$5,250**  
*Receive 5% off TC311411IG shade*

**33' Length** \$5,866.25  
Item #: BL533NE  
**REGULAR PRICE: \$6,175**  
*Receive 5% off TC371511IG shade*

Bundle one of our sale bleachers with its accompanying Superior shade for 5% off the shade.

## Color Schemes



### Autumn

- Red
- Tan
- Orange



### Adventure

- Gray
- White
- Red



### Circus

- Red
- Yellow
- Blue



### Forest

- Burgundy
- Tan
- Dark Green



### NEW! Plum

- Purple
- Butterscotch
- Tan



### NEW! Fortress

- Teal
- Butterscotch
- Tan
- Terracotta

## Color Options

### Metal Colors

- |  |   |   |
|--|---|---|
| <span style="color: yellow;">●</span> Yellow             | <span style="color: blue;">●</span> Blue                | <span style="color: brown;">●</span> Brown*         |
| <span style="color: butterscotch;">●</span> Butterscotch | <span style="color: skyblue;">●</span> Sky Blue         | <span style="color: tan;">●</span> Tan*             |
| <span style="color: orange;">●</span> Orange             | <span style="color: mysticblue;">●</span> Mystic Blue*  | <span style="color: sandstone;">●</span> Sandstone* |
| <span style="color: red;">●</span> Red                   | <span style="color: teal;">●</span> Teal                | <span style="color: gray;">●</span> Gray*           |
| <span style="color: fuchsia;">●</span> Fuchsia           | <span style="color: springgreen;">●</span> Spring Green | <span style="color: black;">●</span> Black*         |
| <span style="color: purple;">●</span> Purple             | <span style="color: green;">●</span> Green*             | <span style="color: white;">●</span> White          |
| <span style="color: burgundy;">●</span> Burgundy*        | <span style="color: sage;">●</span> Sage*               |   |
| <span style="color: marinerblue;">●</span> Mariner Blue* | <span style="color: terracotta;">●</span> Terracotta*   |   |

*\*Available only in semi-gloss.*

### Panel Colors

- |   |  |
|---|--|
| <span style="color: springgreen;">●</span> Spring Green | <span style="color: red;">●</span> Red*          |
| <span style="color: brown;">●</span> Brown*             | <span style="color: burgundy;">●</span> Burgundy |
| <span style="color: terracotta;">●</span> Terracotta    | <span style="color: purple;">●</span> Purple     |
| <span style="color: gray;">●</span> Gray*               | <span style="color: green;">●</span> Green*      |
| <span style="color: tan;">●</span> Tan*                 | <span style="color: teal;">●</span> Teal         |
| <span style="color: yellow;">●</span> Yellow*           | <span style="color: blue;">●</span> Blue*        |
| <span style="color: orange;">●</span> Orange            |  |

*\*Available as 2-color panels.*

### Recycled Deck & Post Colors

- Cedar
- Dark Brown
- Gray



### Plastic Colors



- Red
- Orange
- Yellow
- Light Yellow
- Spring Green
- Light Green
- Dark Green
- Teal Green
- Teal Blue
- Sky Blue
- Royal Blue



- Cobalt Blue
- Purple
- Fuchsia
- Burgundy
- Light Brown
- Brown
- Black
- Gray
- White
- Tan

### Skyspan Fabric Colors

- |              |                 |
|--------------|-----------------|
| ● Black      | ● Aniseed       |
| ● Concrete   | ● Navy          |
| ● Aluminum   | ● Midnight Blue |
| ● Mastic     | ● Lagoon        |
| ○ White      | ● Cornflower    |
| ● Vanilla    | ● Violet Parma  |
| ● Camel      | ● Black Currant |
| ● Cocoa      | ● Burgundy      |
| ● Dead Leaf  | ● Raspberry     |
| ● Beetle     | ● Poppy         |
| ● Moss Green | ● Carrot        |
| ● Tennis     | ● Buttercup     |

### Shelter Roofing Color



### Textured Polyethylene Site Amenity Colors

- |            |                |          |          |         |
|------------|----------------|----------|----------|---------|
| ● Black    | ● VIP Blue     | ● Red    | ● Purple | ● Green |
| ● Brown    | ● Mystic Blue  | ● Orange | ● Gray   |         |
| ● Burgundy | ● Mariner Blue | ● Yellow | ● Clay   |         |

### Shade Fabric Colors



**SAVE  
UP TO  
35%**



**SALE DATES: APRIL 18 - JULY 8, 2016**

Items must be ordered by July 8, 2016 and shipped by July 29, 2016. Prices are for exact unit. All color options are available at no extra charge. Brown steel decks and cedar recycled decks and posts only. Most units will ship 2-3 weeks from order date. Price does not include freight, surfacing, taxes, or installation charges. Additional 5% off with purchase of any Superior shade only applicable for shades whose product numbers begin with "SD" (square) and "RD" (rectangle). 5% off Superior shade with purchase of bleacher only applicable for bleacher and shade pairings listed.

---



1050 Columbia Drive  
Carrollton, GA 30117